

HDS-8104/08/16FTVI-HDMI

Turbo HD DVR

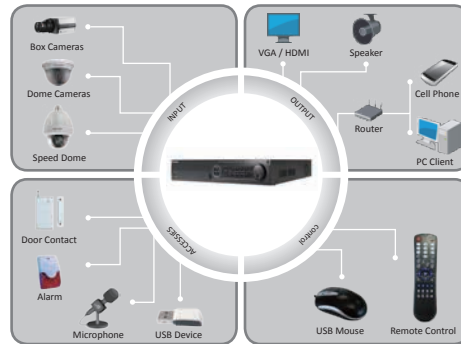

Key features

- H.264 & Dual-stream video compression
- Support HD-TVI/analog/IP camera triple hybrid
- Support both HD-TVI and analog cameras with adaptive access
- Full channel@1080P resolution real-time recording
- HDMI and VGA output at up to 1920×1080P resolution
- Long transmission distance over coax cable
- Support up to 16-ch synchronous playback at 1080P resolution

Rear Panel

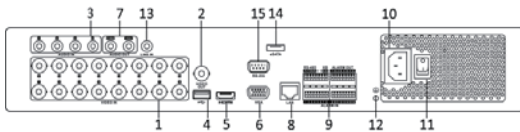

- 1 VIDEO IN
- 2 VIDEO OUT
- 3 AUDIO IN, RCA Connector
- 4 USB Port
- 5 HDMI Interface
- 6 VGA Interface
- 7 CVBS AUDIO OUT and VGA AUDIO OUT
- 8 LAN1 LAN2 Network Interfaces
- 9 RS-485 Serial Interface, Keyboard Interface, ALARM IN and ALARM OUT
- 10 100~240V AC Power Input
- 11 Power Switch
- 12 GND
- 13 LINE IN
- 14 eSATA Interface
- 15 RS-232 Serial Port

	HDS-8104FTVI-HDMI	HDS-8108FTVI-HDMI	HDS-8116FTVI-HDMI
Video/Audio input			
Video compression	H.264		
Analog and HD-TVI video input	4-ch	8-ch	16-ch
	BNC interface (1.0Vp-p, 75 Ω)		
Supported camera types	720P25, 720P30, 720P50, 720P60, 1080P25, 1080P30, CVBS		
Audio compression	G.711u		
Audio input	4-ch	8-ch	16-ch
	RCA (2.0 Vp-p, 1 KΩ)		
Two-way audio in	1-ch, RCA (2.0 Vp-p, 1 KΩ)		
Video/Audio output			
HDMI / VGA output	1920 × 1080 / 60 Hz, 1280 × 1024 / 60 Hz, 1280 × 720 / 60 Hz, 1024 × 768 / 60 Hz		
CVBS output	1-ch, BNC (1.0 Vp-p, 75 Ω), resolution: PAL: 704 × 576, NTSC: 704 × 480		
Encoding resolution	Main stream: 1080P / 720P / VGA / 4CIF / CIF Sub-stream: WD1 (non-real-time) / 4CIF(non-real-time) / CIF / QCIF / QVGA		
Frame rate	Main stream: 1/16 fps ~ Real time frame rate Sub-stream: 1/16 fps ~ Real time frame rate		
Video bitrate	32 Kbps-10 Mbps		
Audio output	2-ch, RCA (Linear, 1KΩ, for VGA output and CVBS output respectively)		
Audio bitrate	64 Kbps		
Dual-stream	Support		
Stream type	Video, Video & Audio		
Synchronous playback	4-ch	8-ch	16-ch
Playback resolution	1080P / 720P / VGA / WD1 / 4CIF / CIF / QVGA / QCIF		
Network management			
Remote connections	128		
Network protocols	TCP/IP, PPPoE, DHCP, DNS, DDNS, NTP, SADP, SMTP, SNMP, NFS, iSCSI, UPnP™, HTTPS		
Hard disk			
Type	8 SATA interfaces for 8 HDDs; 1 eSATA interface		
Capacity	Up to 4 TB capacity for each disk		
External interface			
Network interface	2; 10M / 100M / 1000M self-adaptive Ethernet interfaces		
Serial interface	RS-232, RS-485, Keyboard		
USB port	3 × USB2.0		
Alarm in / out	16 / 4		
General			
Power supply	100 ~ 240VAC, 47 ~ 63HZ		
Consumption (without hard disks)	≤ 35W	≤ 45W	≤ 65W
Working temperature	-10 °C ~+55 °C (14 °F ~ 131 °F)		
Working humidity	10% ~ 90%		
Chassis	19-inch rack-mounted 2U chassis		
Dimensions (W × D × H)	445 × 470 × 90 mm (17.5 × 18.5 × 3.5 inch)		
Weight (without hard disks)	≤ 8Kg (17.6 lb)		